

## Skriveni klizači PUSH 3D

### Montaža skrivenih push klizača i 3D spojnice

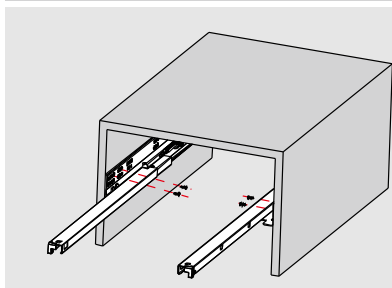

Montirati klizač na stranice korpusa

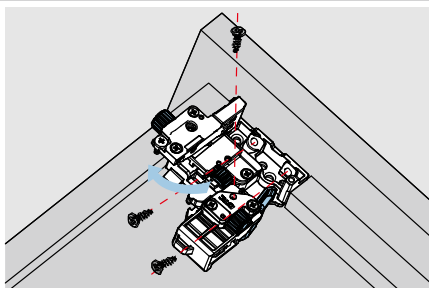

Montirati spojnicu šrafovim sa donje strane

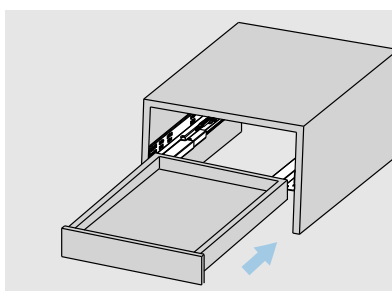
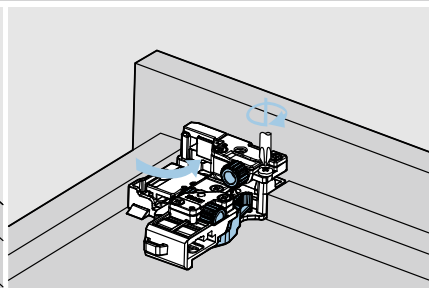

Ubaciti fioku na klizače

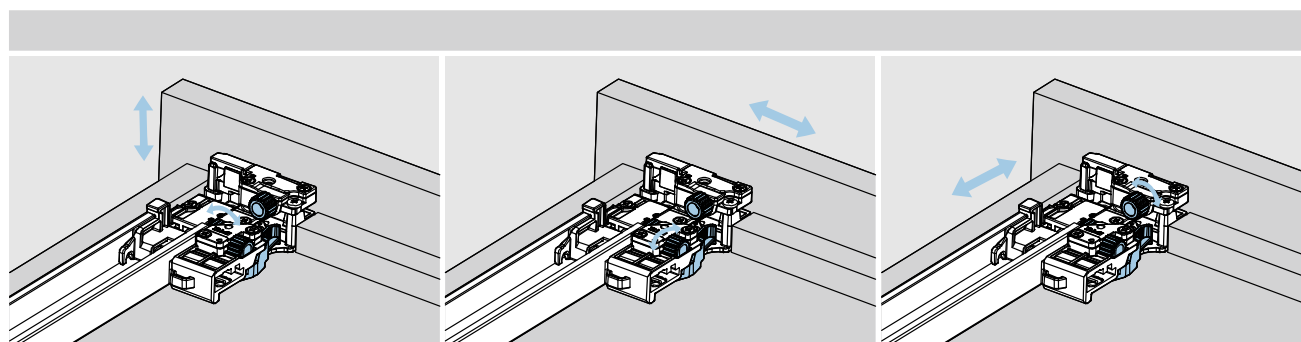
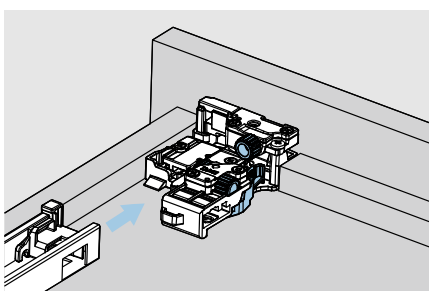

Podešavanje po visini

Podešavanje po širini

Podešavanje po dubini

### Uklanjanje

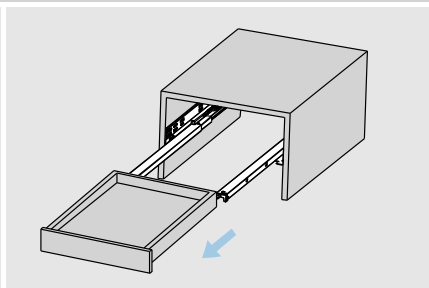
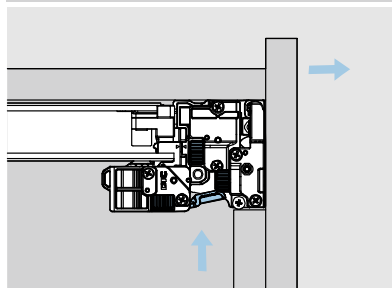

Pritisnite polugu na spojnici da biste izvukli fioku

## Sinhro šipka

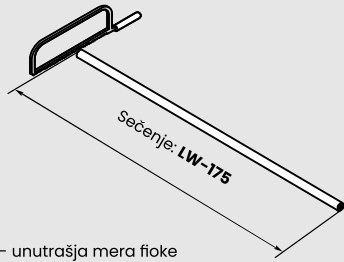

LW - unutrašnja mera fioke

Isecite šipku tako da odgovara unutrašnjoj meri fioke

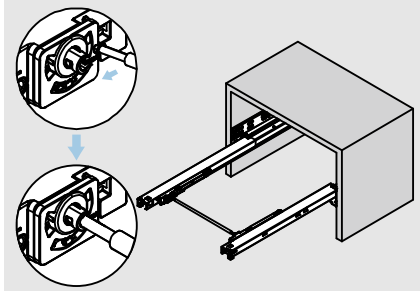
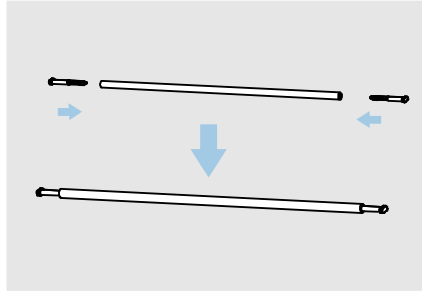

Montirajte šipku na klizače

## Podešavanje razmaka

