

SGE-G Al ram za izradu staklenih plakarskih vrata

Staklo 4mm

SGE GA OP Horizontalna puna AL

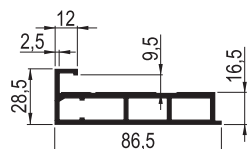
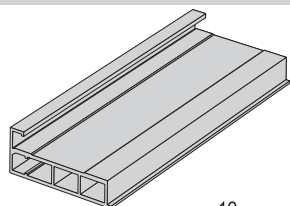

		šifra
m	SM	4181

SGE GA OP Pregradni profil AL

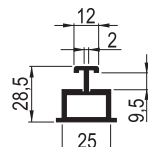
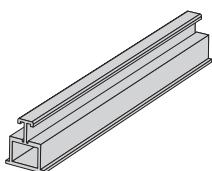

		šifra
m	SM	4184

SGE GA OP Vezni profil AL

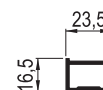
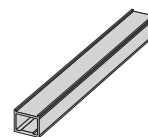

		šifra
m	SM	4185

Prodajne dimenzije profila (m): 1; 1,5; 2; 2,5; 3; 4; 6

SGE GA OP Rukohvat obli AL

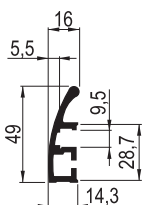
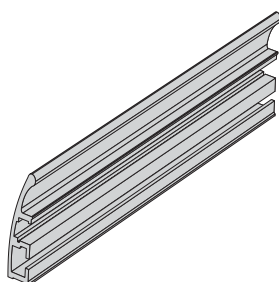

		šifra
m	SM	4179

SGE GA OP Rukohvat ravni AL

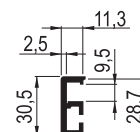
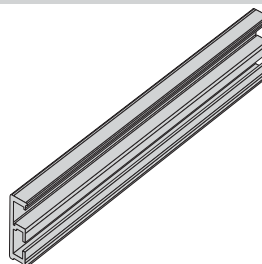

		šifra
m	SM	4180

Prodajne dimenzije rukohvata: 2.75 i 5.5m

SGE GA OP Vezni mehanizam

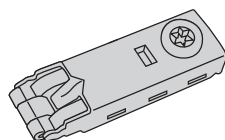

		šifra
kom	metal	4187

SGE GA OP PVC ispuna st. 4mm

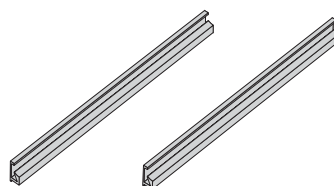

		šifra
m	SM	4186

Prodajna dimenzija profila: 3m

Aluminijumski ram za SGE-G klizni mehanizam

DIMENZIJE VRATA

(Ako se koristi jedan obli i jedan ravni rukohvat na vratima)

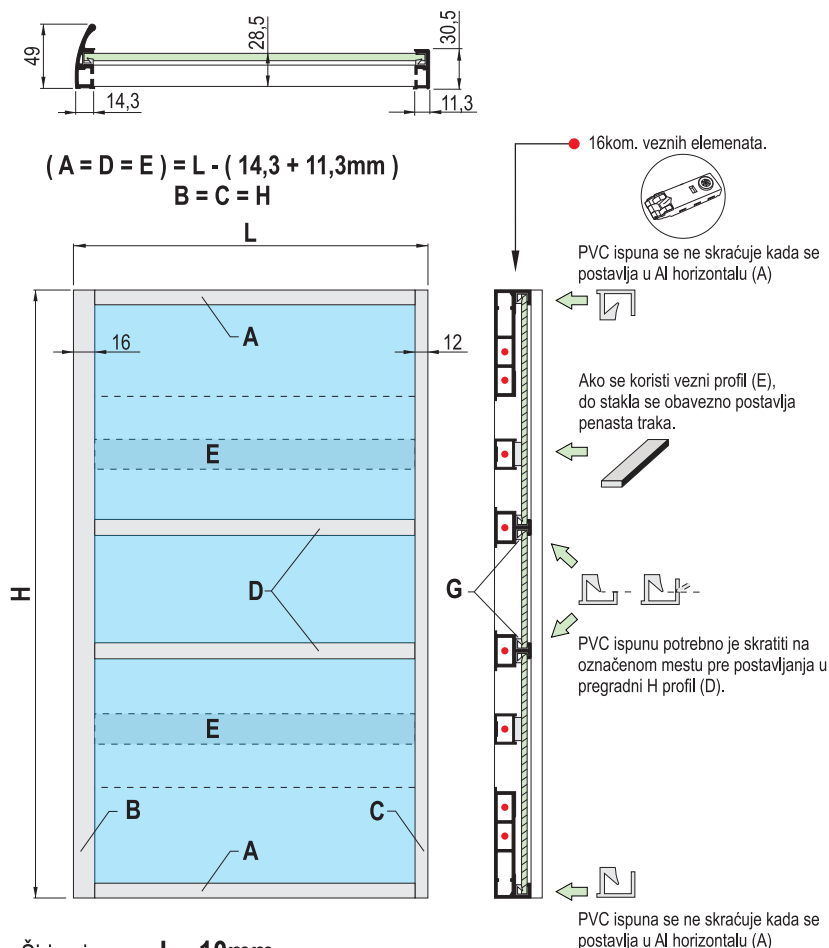

$$(A = D = E) = L - (14,3 + 11,3\text{mm})$$

$$B = C = H$$

DIMENZIJE VRATA

(Ako se koriste dva obla rukohvata na vratima)

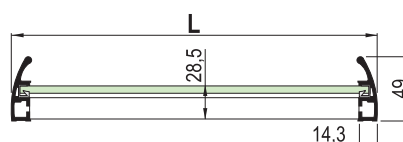

$$(A = D = E) = L - (14,3\text{mm} \times 2)$$

$$B = H$$

Širina ispune: **L - 12mm**

Visina ispune: **H - 8mm (bez H profila)**

* Za svaki H profil na vratima oduzima se po 3mm od ukupne visine vrata H.

DIMENZIJE VRATA

(Ako se koriste dva ravna rukohvata na vratima)

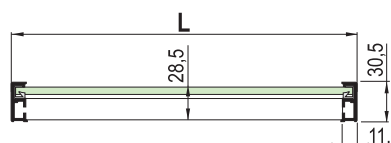

$$(A = D = E) = L - (11,3\text{mm} \times 2)$$

$$C = H$$

Širina ispune: **L - 8mm**

Visina ispune: **H - 8mm (bez H profila)**

* Za svaki H profil na vratima oduzima se po 3mm od ukupne visine vrata H.

Širina ispune: **L - 10mm**

Visina ispune: **H - 8mm (bez H profila)**

* Za svaki H profil na vratima oduzima se po 3mm od ukupne visine vrata H.

Ako se koriste svi Al profili kao na primeru sa slike iznad, onda je za spajanje potrebno 16kom. veznih elemenata.

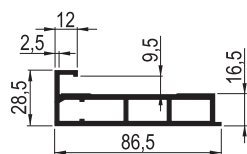

(A)

SGE GA OP Al horizontala - puna
Dužina: 1m-6m
Šifra: 4181

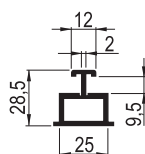

(D)

SGE GA OP Al pregradni profil
Dužina: 1m-6m
Šifra: 4184

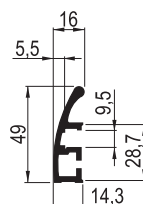

(B)

SGE GA OP Al rukohvat obli
Dužina: 2,75m-5,5m
Šifra: 4179

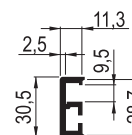

(C)

SGE GA OP Al rukohvat ravni
Dužina: 2,75m-5,5m
Šifra: 4180

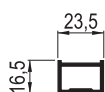

(E)

SGE GA OP Al vezni profil
Dužina: 1m-6m
Šifra: 4185



(G)

SGE GA OP Ispuna PVC
Dužina: 3m
Šifra: 4186



SGE GA OP Vezni element
Šifra: 4187

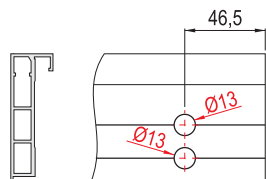

(A) EP-G OP Al horizontale pune

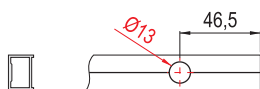

(E) EP-G OP Al vezni profil

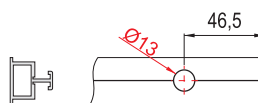

(D) EP-G OP Al pregradni profil

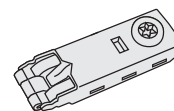

Vezni element

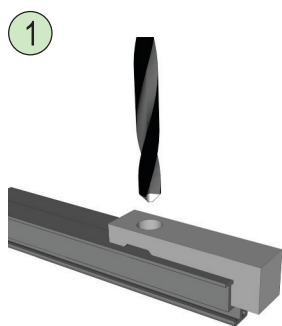

1

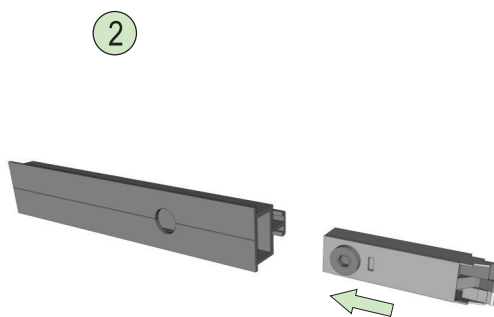

2

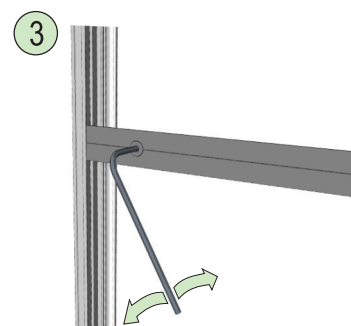

3

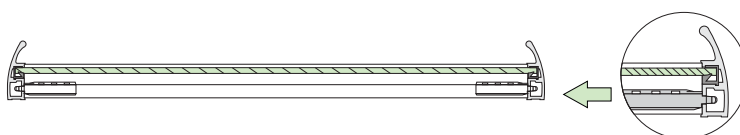

Veznih elemenata
10kom.

