



Sistemi i profili za izradu kliznih plakarskih vrata



europrofil

SS SI 2010 sistem za laka klizna staklena vrata

| | | |
|--|---|---|
|  6kg |  Staklo 5mm 6mm |  ±2mm |
|--|---|---|

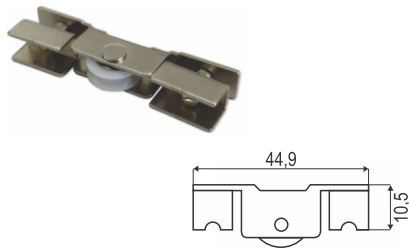

SS SI 2010 met.mehanizam



| | | |
|---|---|---|
|  |  |  |
| kom | metal | šifra |
| | | 5888 |

SS SI 2010 čep donje vodice



| | | |
|---|---|---|
|  |  |  |
| kom | metal | šifra |
| | | 5883 |

SS SI 2010 bravica



| | | |
|---|---|---|
|  |  |  |
| kom | SM | šifra |
| | | 5882 |

SS SI 2010 bravica isti ključ*



| | | |
|---|---|---|
|  |  |  |
| kom | SM | šifra |
| | | 6300 |

SS SI 2010 gornja šina 2m AL SM

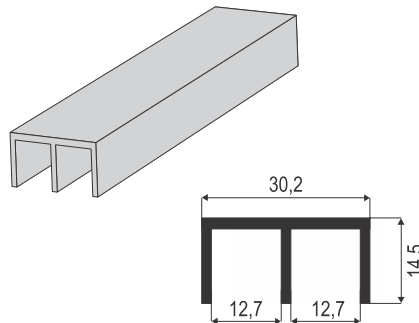

| | | |
|---|---|---|
|  |  |  |
| 2m | SM | šifra |
| | | 5886 |

SS SI 2010 donja šina 2m AL SM

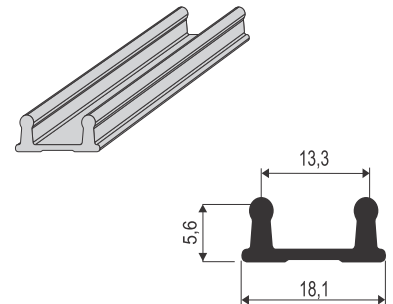

| | | |
|---|---|---|
|  |  |  |
| 2m | SM | šifra |
| | | 5884 |

SS SI 2010 donja vodica 2m AL SM

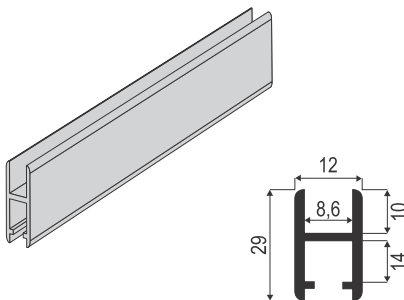

| | | |
|---|---|---|
|  |  |  |
| 2m | SM | šifra |
| | | 5885 |

SS SI 2010 PVC za donju vodicu

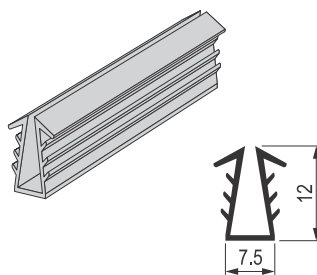

| | | |
|---|---|---|
|  |  |  |
| m | siva | šifra |
| | | 5887 |

SS SI 2010 PVC za gornju vodicu

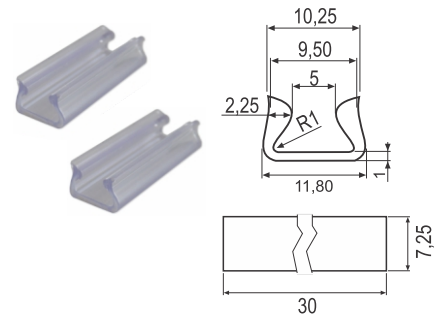

| | | |
|---|---|---|
|  |  |  |
| kom | trans. | šifra |
| | | 5889 |

Tehnički crteži SS SI 2010 bravice

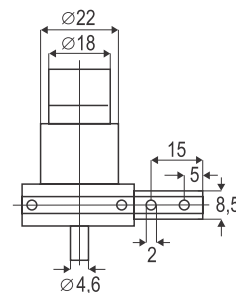
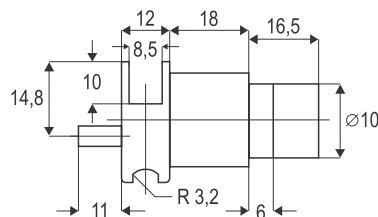
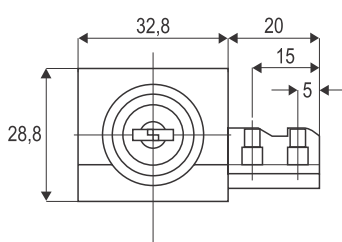

*Isti ključ (Key Alike), je varijanta bravice koja omogućava otključavanje više bravica istim ključem.

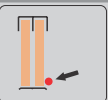

FW = Širina korpusa (unutrašnja dimenzija)
 GW = Širina staklene ispune
 FH = Visina korpusa (unutrašnja dimenzija)
 GH = Visina staklene ispune
 R = Dužina donje vođice (za vrata bez bravice)
 R_{Lock} = Dužina donje vođice (za vrata sa bravicom)

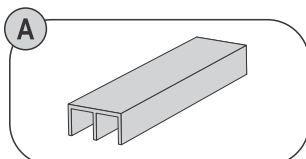
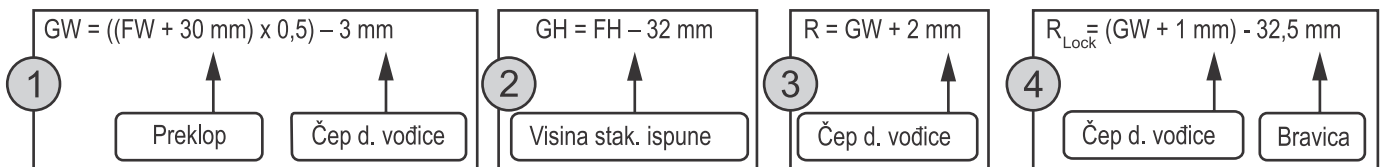
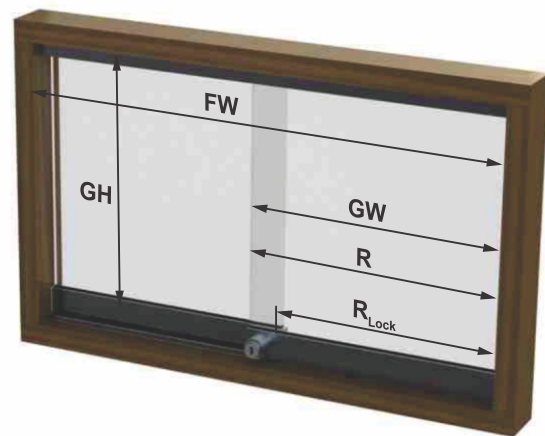

SS SI 2010 gornja šina



SS SI 2010 PVC za gor.šinu

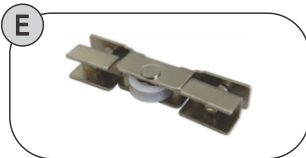

SS SI 2010 met. mehan.

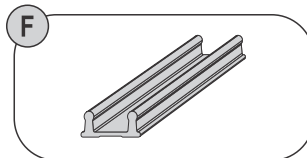

SS SI 2010 donja Al šina



SS SI 2010 čep d.vođice

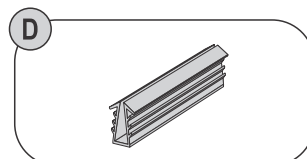

SS SI 2010 PVC za d.vođicu

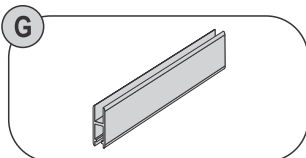

SS SI 2010 Al d.vođica

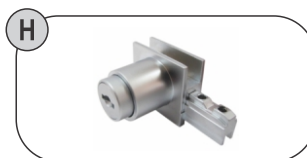

SS SI 2010 bravica

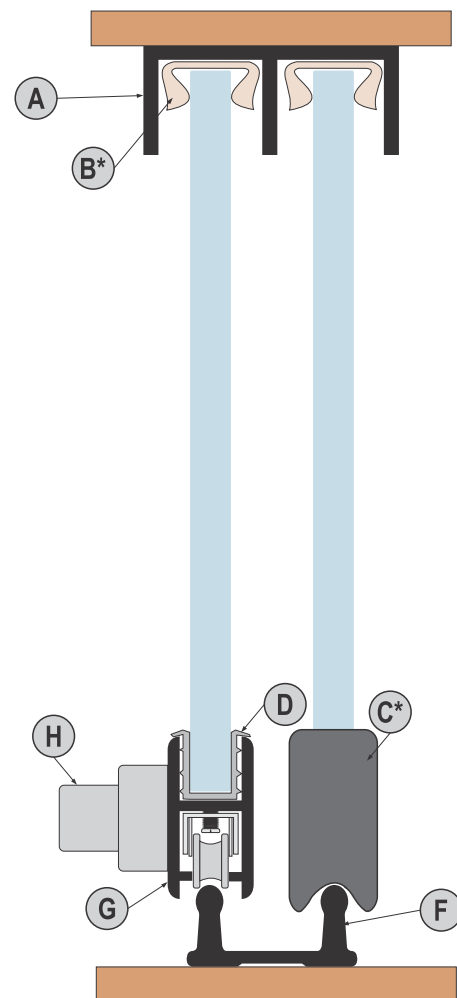

B* SI 2010 PVC umetak za gornju šinu: koristi se 5 komada na 1m.

C* SI 2010 čep donje vođice: Postavljaju se 2 kom na klizna vrata osim u slučaju kada se na vrata postavlja SI 2010 bravica, u tom slučaju se postavlja samo 1 čep.